



Minipack-torre S.p.A.
Via Provinciale, 54 - 24044 Dalmine (BG) - Italy
Tel. (035) 563525 – Fax (035) 564945
E-mail: info@minipack-torre.it
<http://www.minipack-torre.it>



Media Matic

Catalogo ricambi

(Valido dalla matricola nr. 102 del 02.2000 fino alla matricola 1283 del 01.2011)

Spare parts catalogue

(Valid from serial number 102 dated 02.2000 up to 1283 dated 01.2011)



CONSULTARE ATTENTAMENTE QUESTO CATALOGO PRIMA DI ORDINARE PEZZI DI RICAMBIO
CAREFULLY READ THIS CATALOGUE BEFORE ORDERING ANY SPARE PART



DOC. N. FM112018
REV. 02
ED. 09.2011

УПАКОВОЧНОЕ ОБОРУДОВАНИЕ



ПРОИЗВОДСТВО И ПОСТАВКА
СЕРВИСНЫЙ РЕМОНТ
ЗАПАСНЫЕ ЧАСТИ
РАСХОДНЫЕ МАТЕРИАЛЫ

Диагностика, ремонт, сервисное обслуживание.

Запасные части и расходный материал: резина, тефлоновая лента, термонож (лезвие), гель для смазки.

Плѐнка термоусадочная полиолефиновая.

Система «Trade-In» – замена Вашего оборудования на новое и более производительное.



На фото: запайщик Magnetic FL900 + туннель Magnetic T100

ООО «АРДсистемы»

(495) 231-21-00

(812) 363-20-22

info@ardsystems.ru

www.filmtrade.ru

www.ardsystems.ru

INDICE GRUPPI DI RICAMBIO / INDEX OF SPARE PARTS GROUPS

TAVOLA SCHEME	DESCRIZIONE DESCRIPTION	PAGINA PAGE
1	GRUPPO LAMA SALDANTE SEALING BLADE GROUP	2
2	GRUPPO TAGLIERINA CUTTER GROUP	3
3	GRUPPO SUPPORTO BOBINA FILM ROLL SUPPORT GROUP	4
4	GRUPPO AUTOMAZIONE TAGLIERINA CUTTER AUTOMATION GROUP	5
5	GRUPPO NASTRO TRASPORTATORE TRANSPORT BELT GROUP	6
6	GRUPPO RAFFREDDAMENTO COOLING GROUP	7
7	GRUPPO AVVOLGITORE FILM FILM WINDER GROUP	8
8	GRUPPO CARENATURA BODYWORK GROUP	9
9	GRUPPO NASTRO TRASPORTATORE TUNNEL (ingresso) CONVEYOR BELT TUNNEL GROUP (inlet side)	10
9.1	GRUPPO NASTRO TRASPORTATORE TUNNEL (uscita) CONVEYOR BELT TUNNEL GROUP (outlet side)	11
9.2	GRUPPO NASTRO TRASPORTATORE TUNNEL (catena) CONVEYOR BELT TUNNEL GROUP (chain)	12
10	GRUPPO MOTORE + RESISTORI MOTOR + HEATERS GROUP	13
11	GRUPPO ELETTRICO (pannello comandi) WIRING GROUP (control panel)	14
11.1	GRUPPO ELETTRICO (cassetto) WIRING GROUP (box)	14
12	SCHEMA ELETTRICO WIRING DIAGRAM	15-16
12.1	LEGENDA SCHEMA ELETTRICO WIRING DIAGRAM DESCRIPTION	17

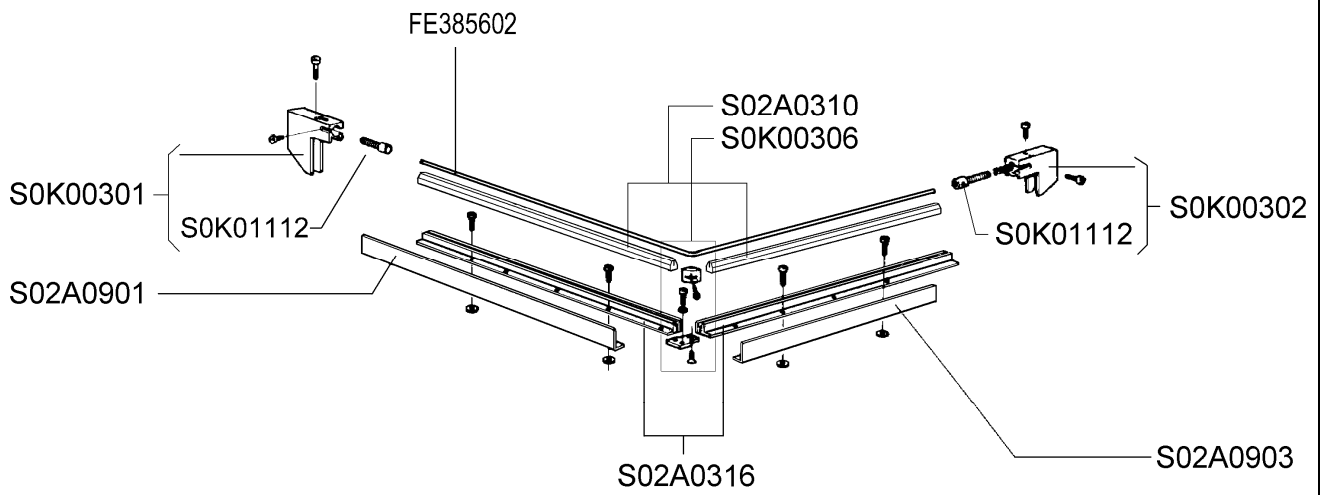

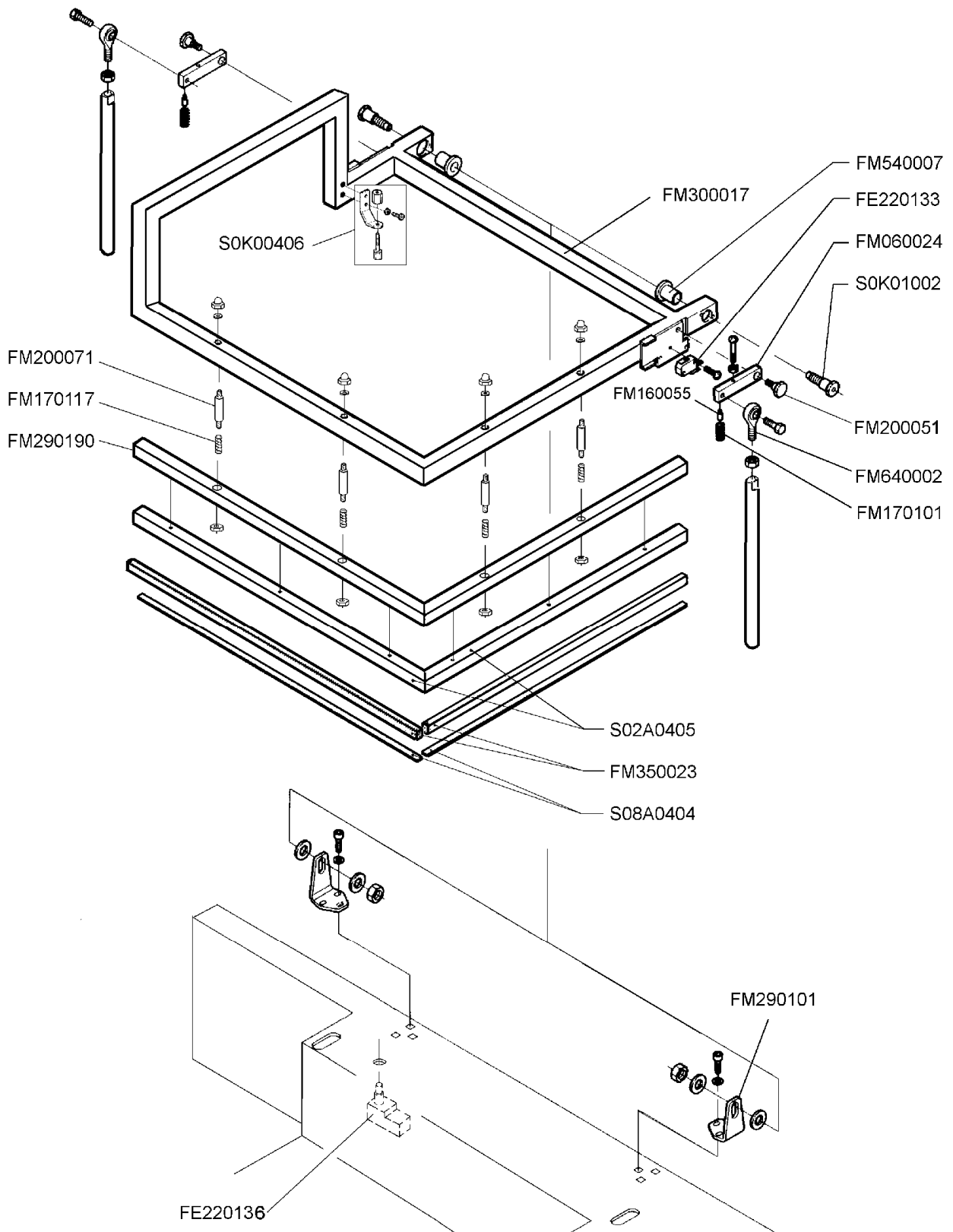

S03A0606

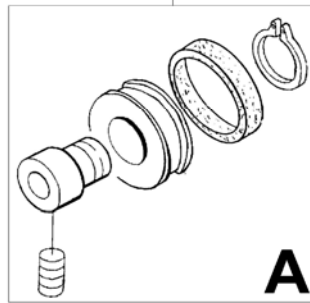

S03A0605

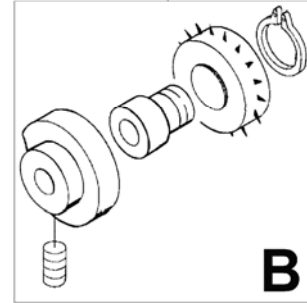

FM710315

FM660002

FM090712 (RAL7032 B.)

FM090714 (RAL7040 L.)

FM220504

A

B

S08A0603

S08A0602

PB17B001 (RAL7032 B.)

PB17B002 (RAL7040 L.)

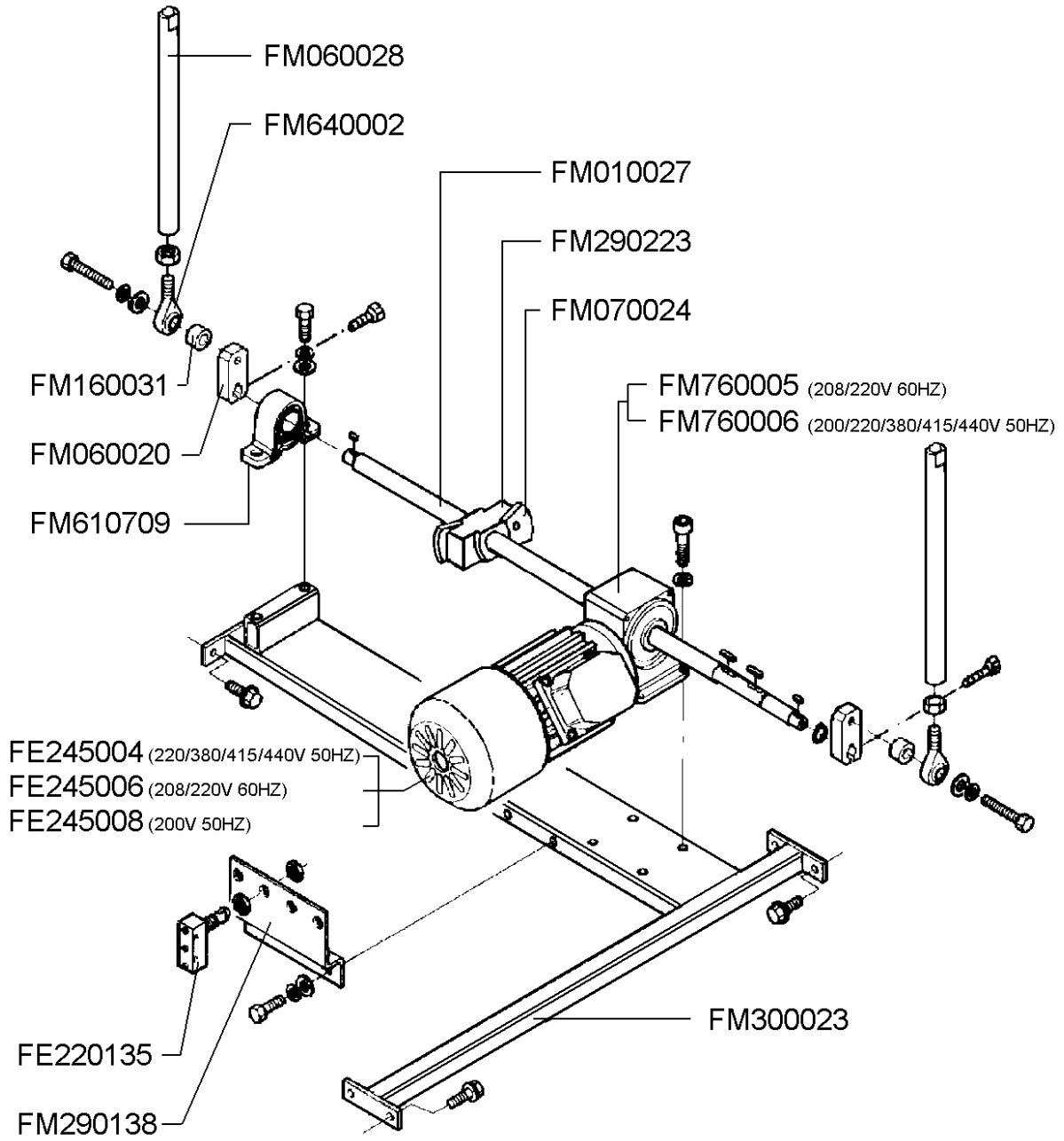

GRUPPO NASTRO TRASPORTATORE TRANSPORT BELT GROUP

TAVOLA 5 SCHEME 5

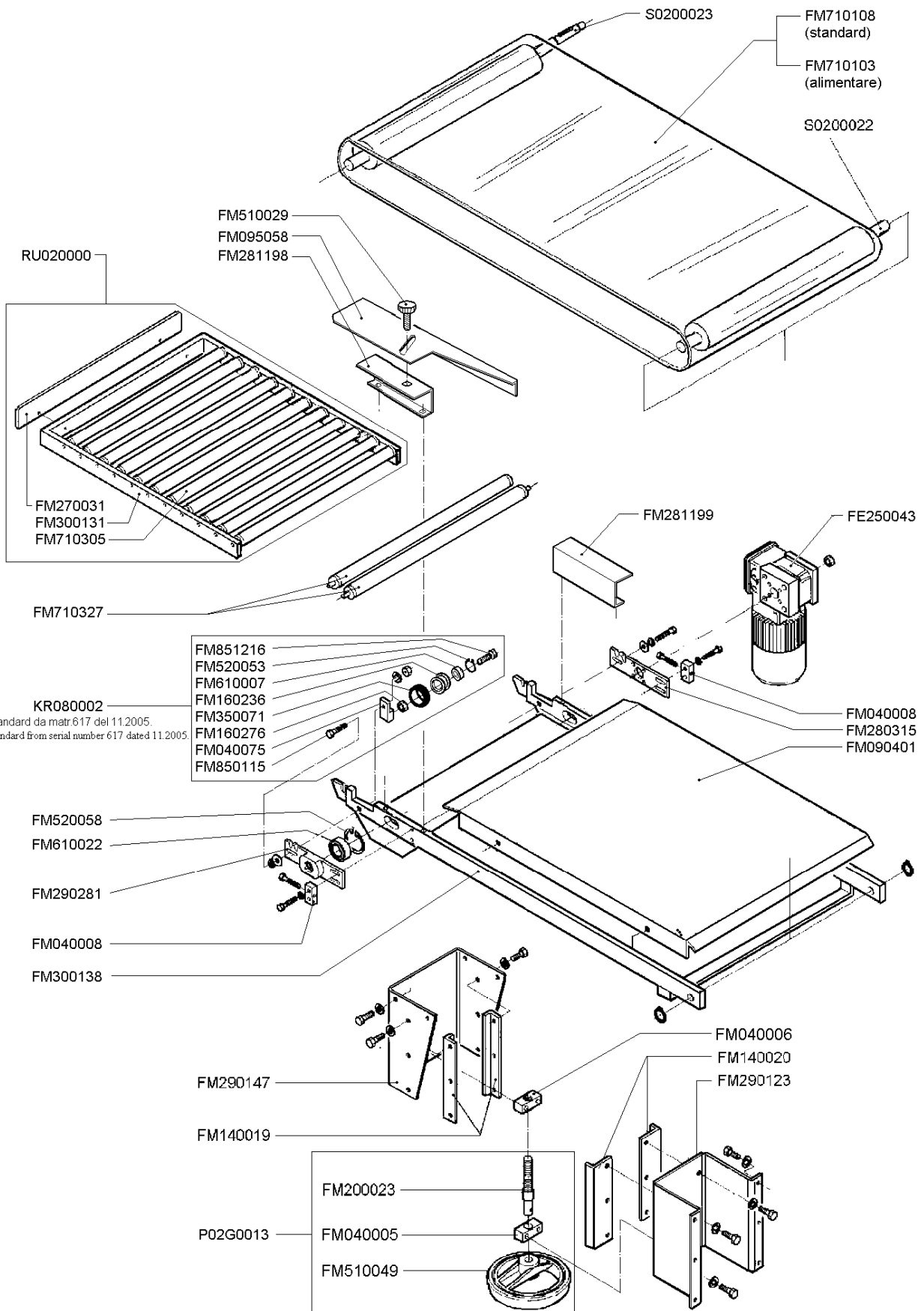

**GRUPPO RAFFREDDAMENTO
COOLING GROUP**

**TAVOLA 6
SCHEME 6**

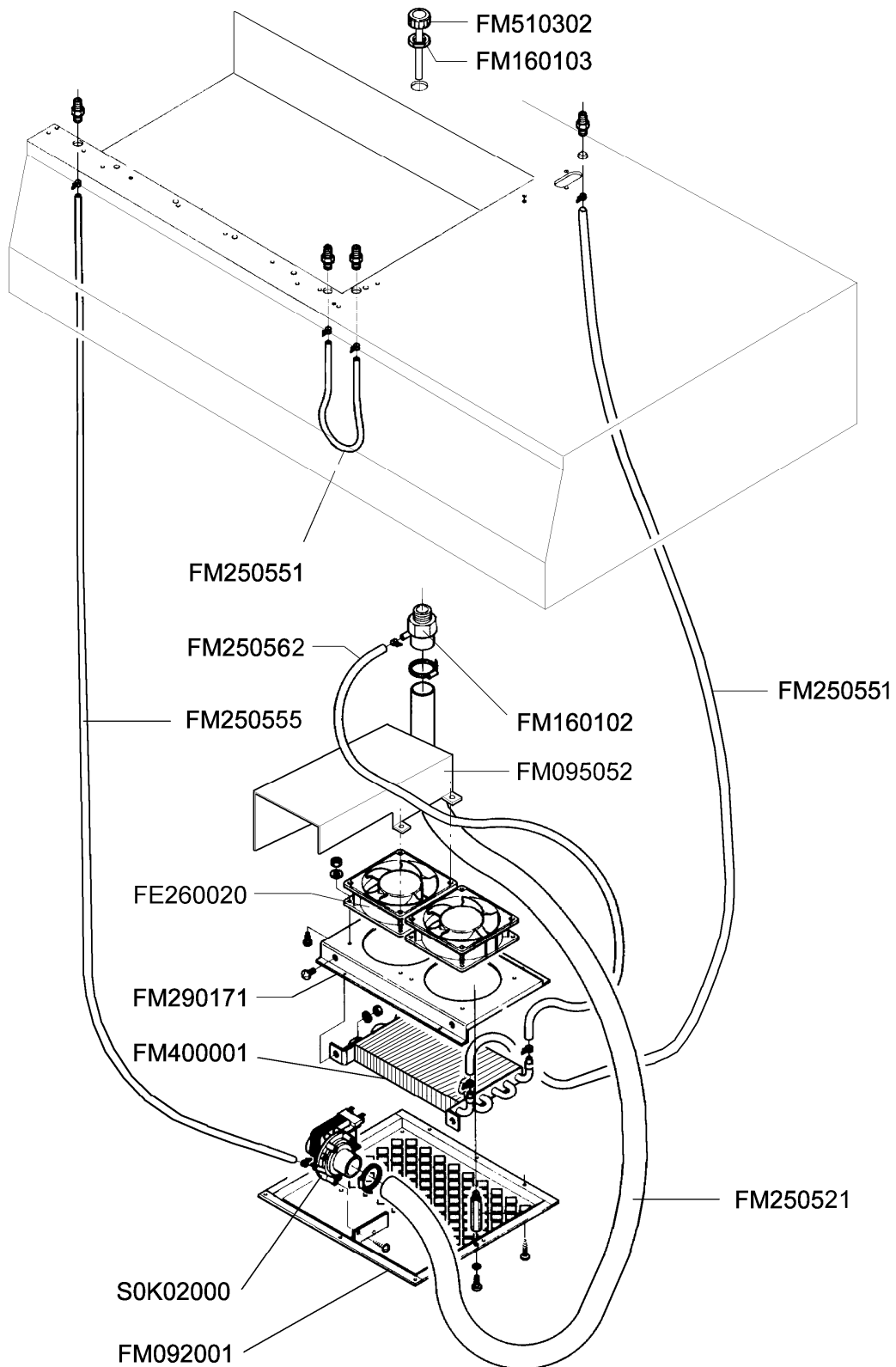

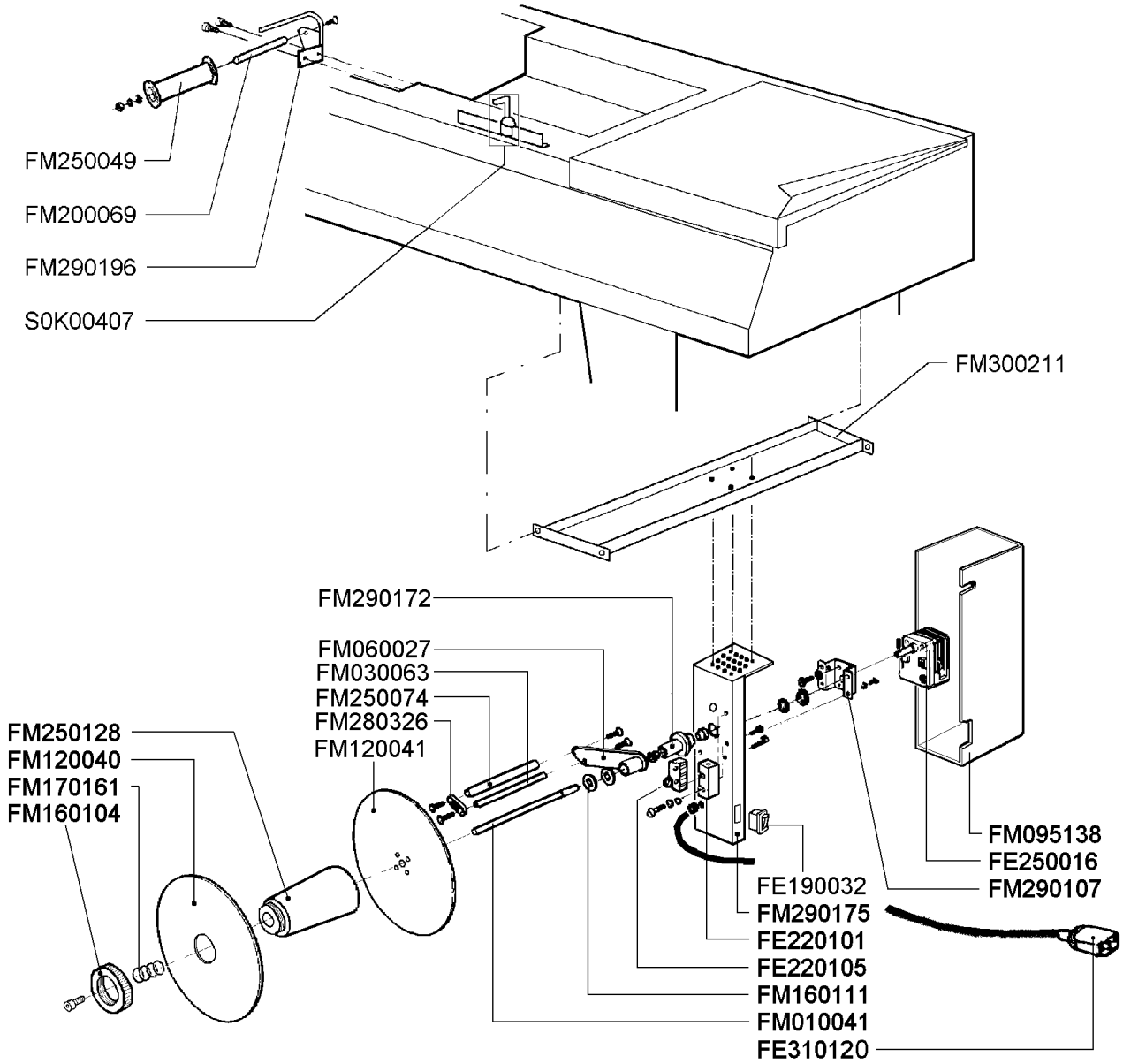

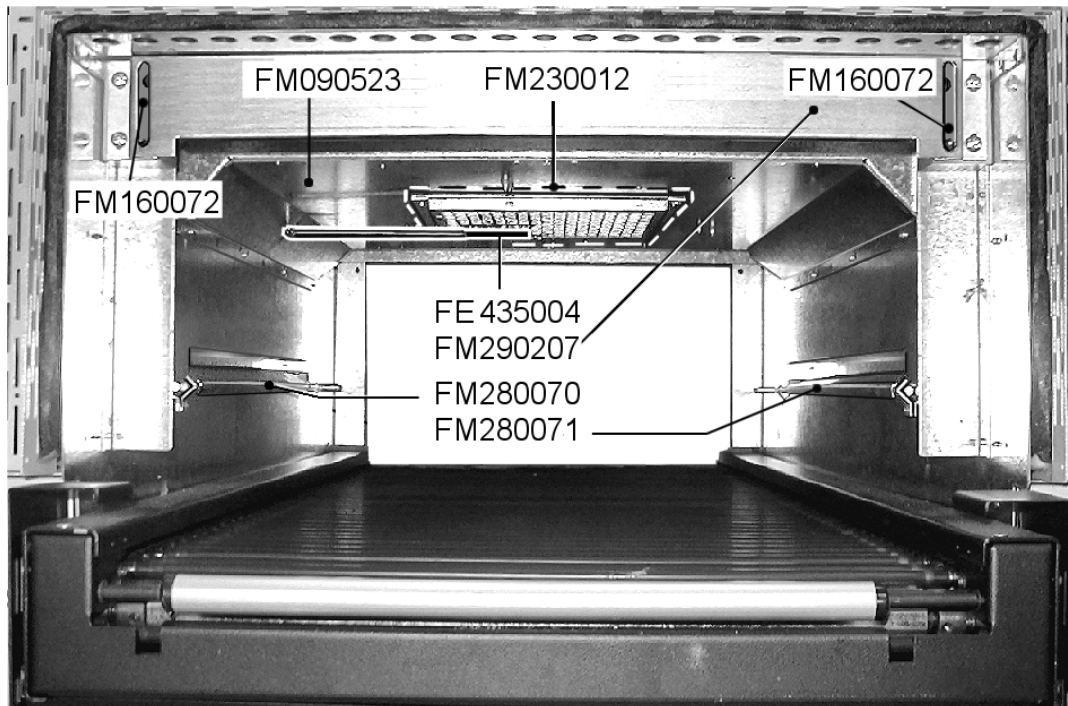
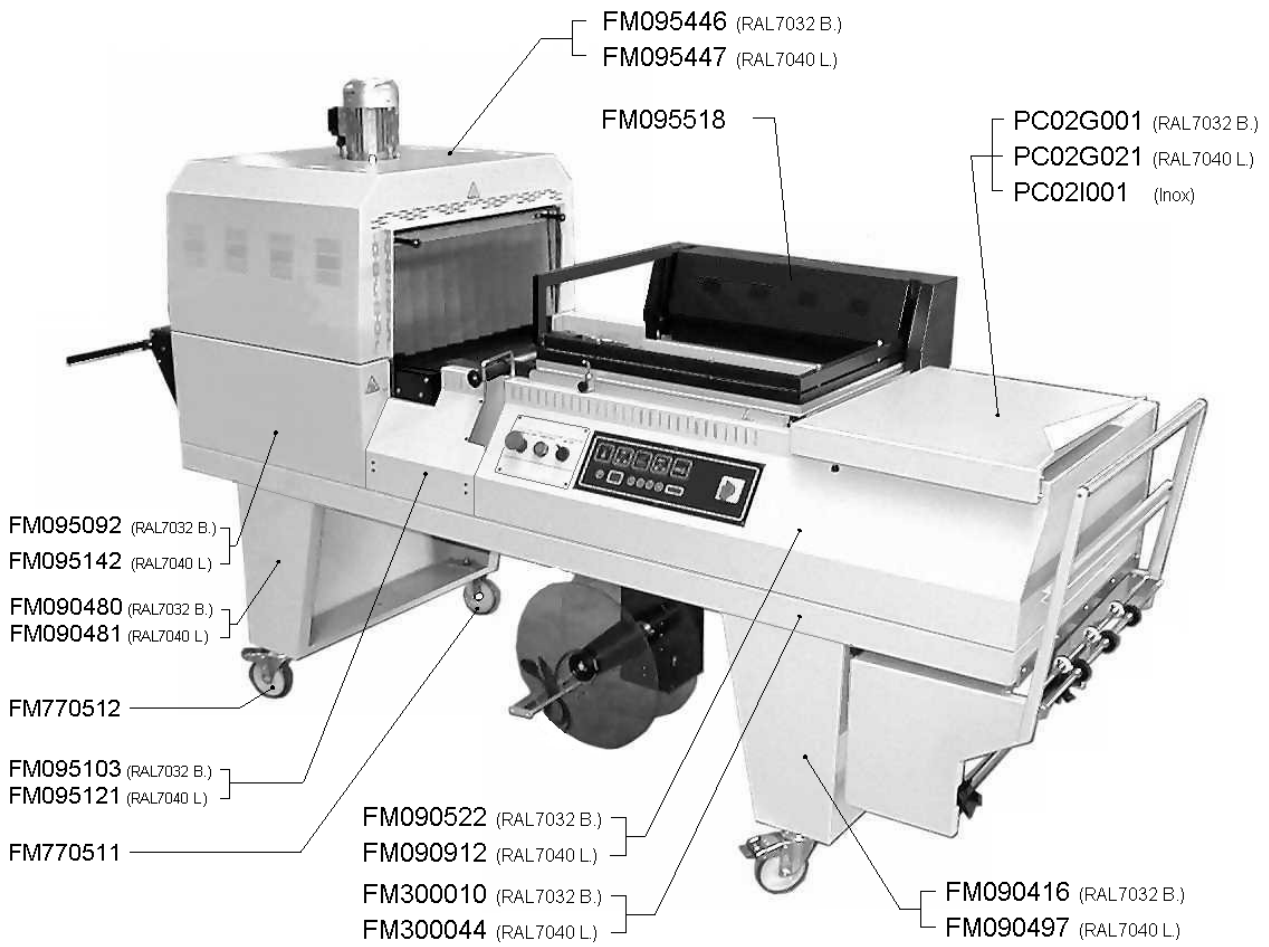

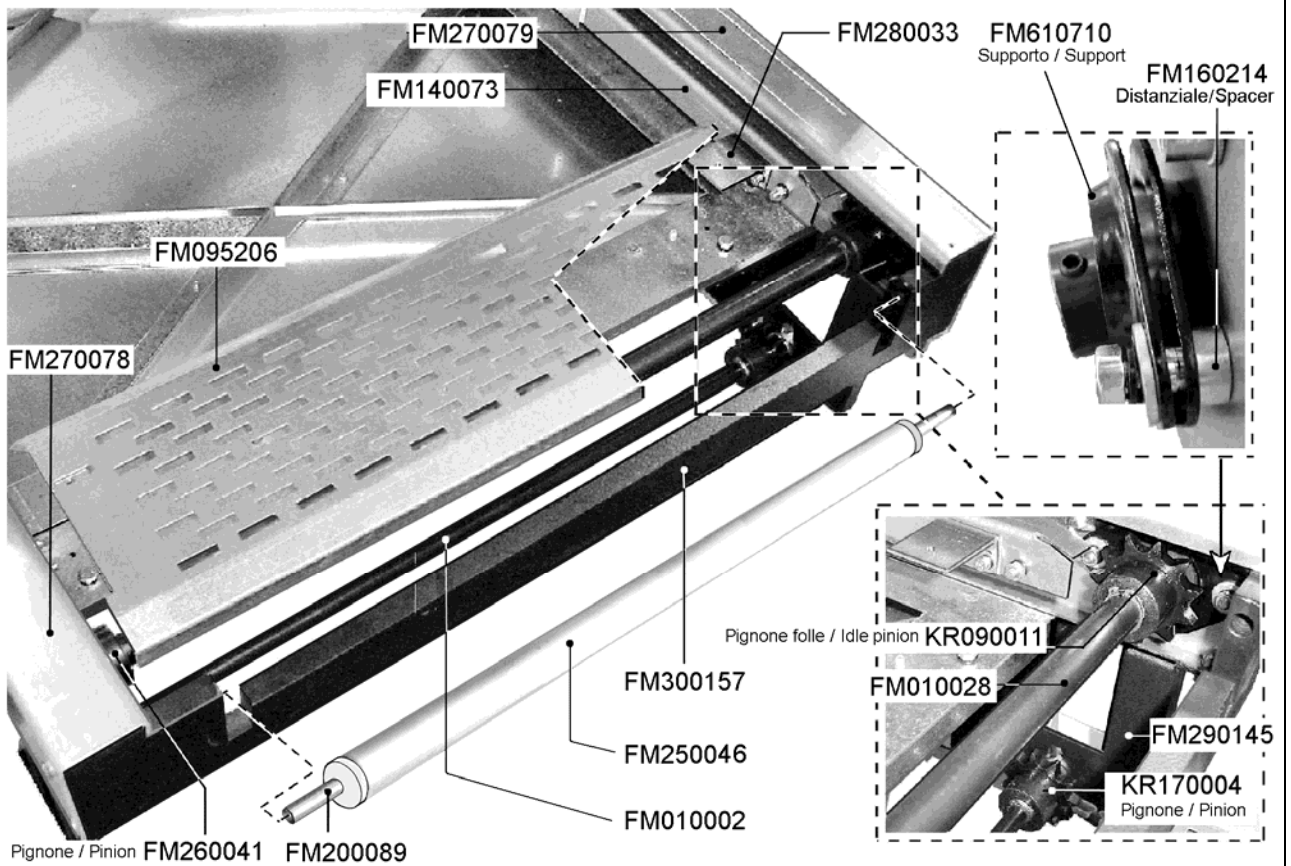
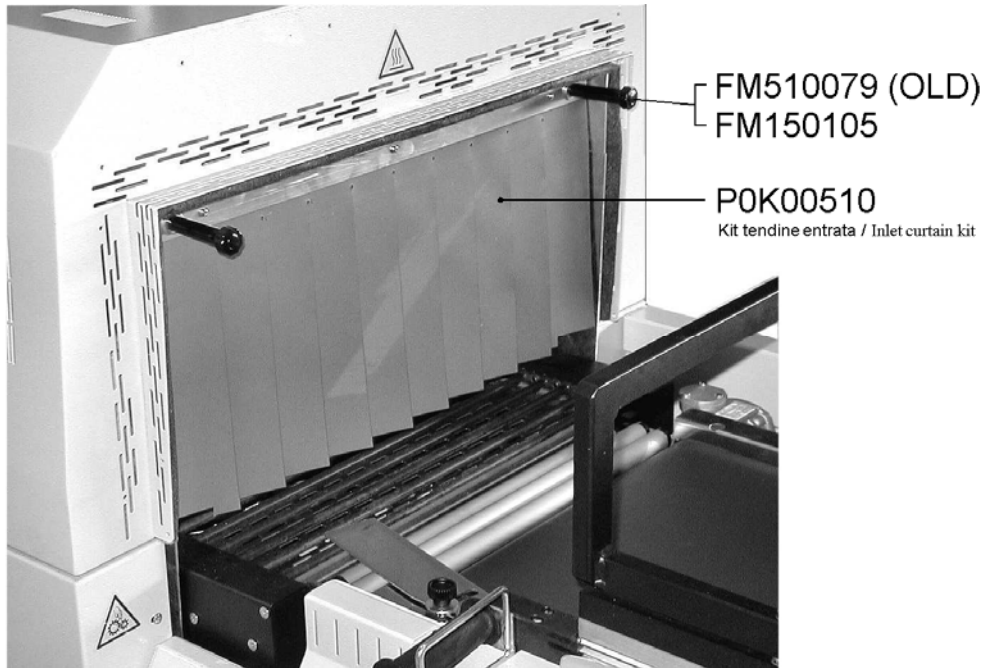

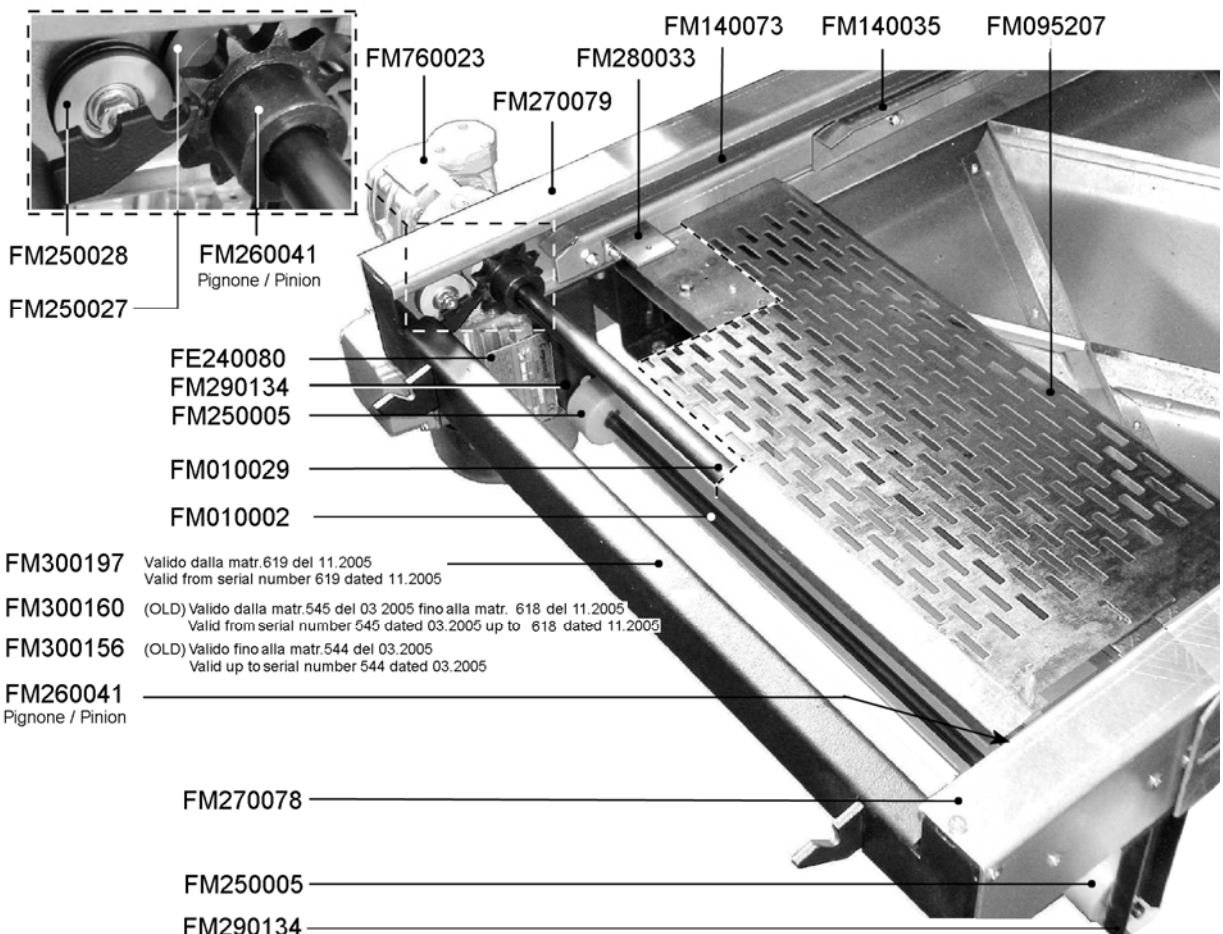
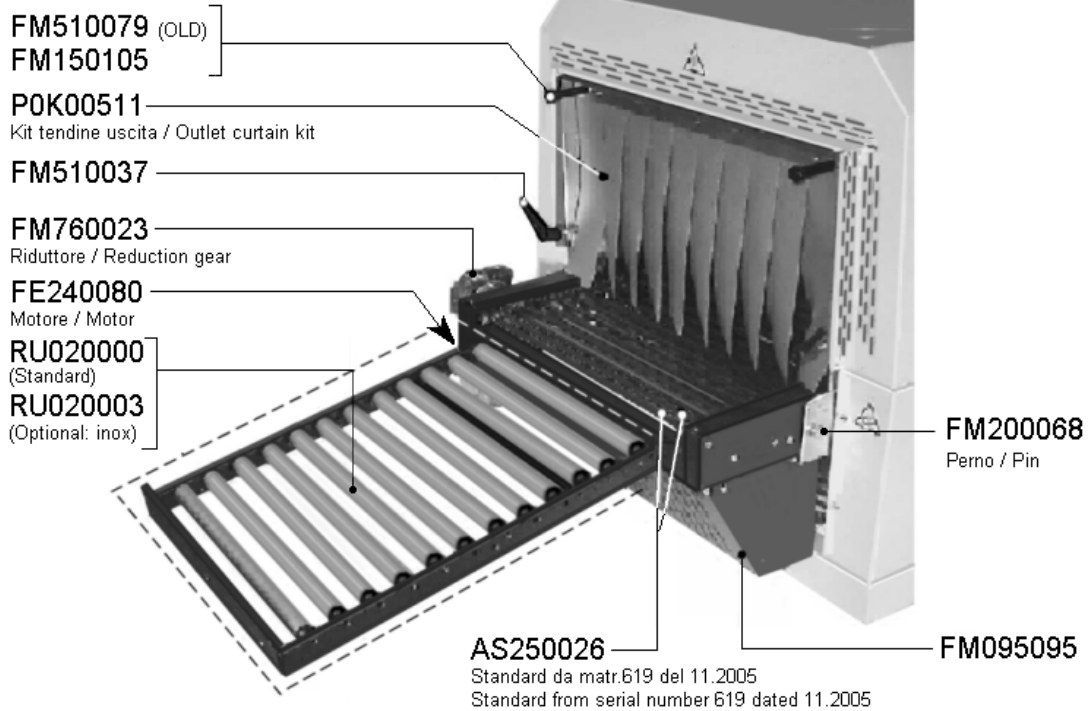

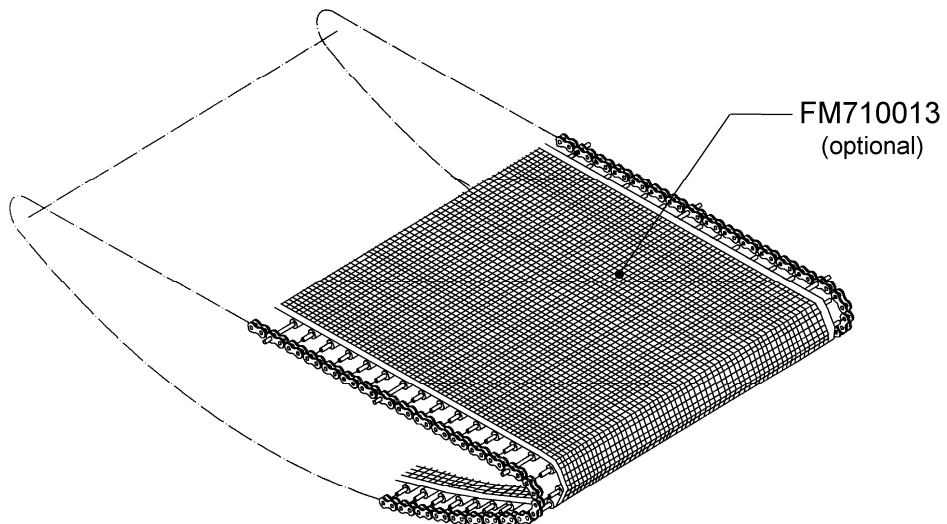
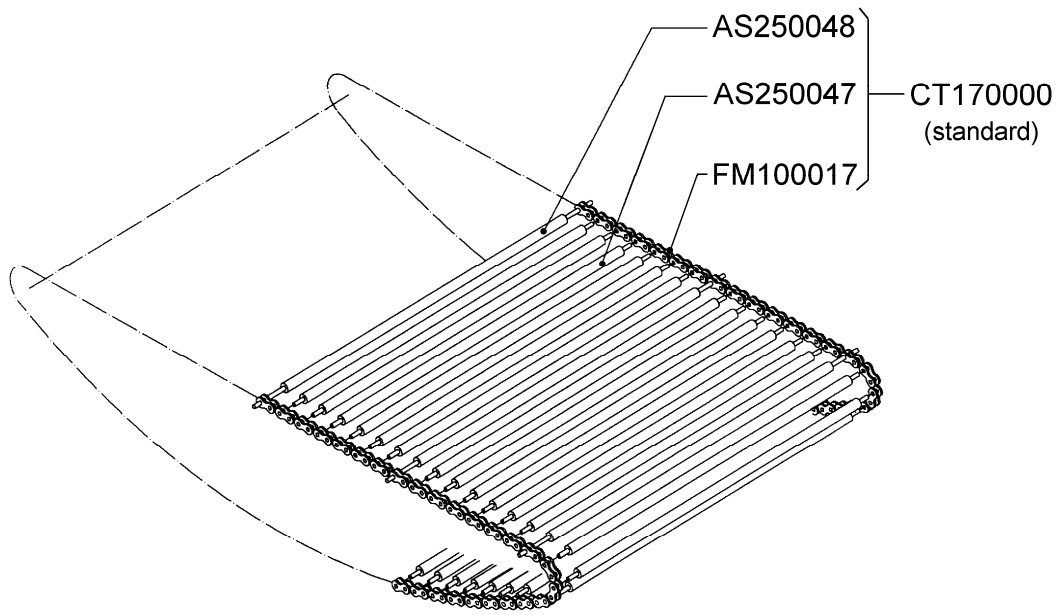

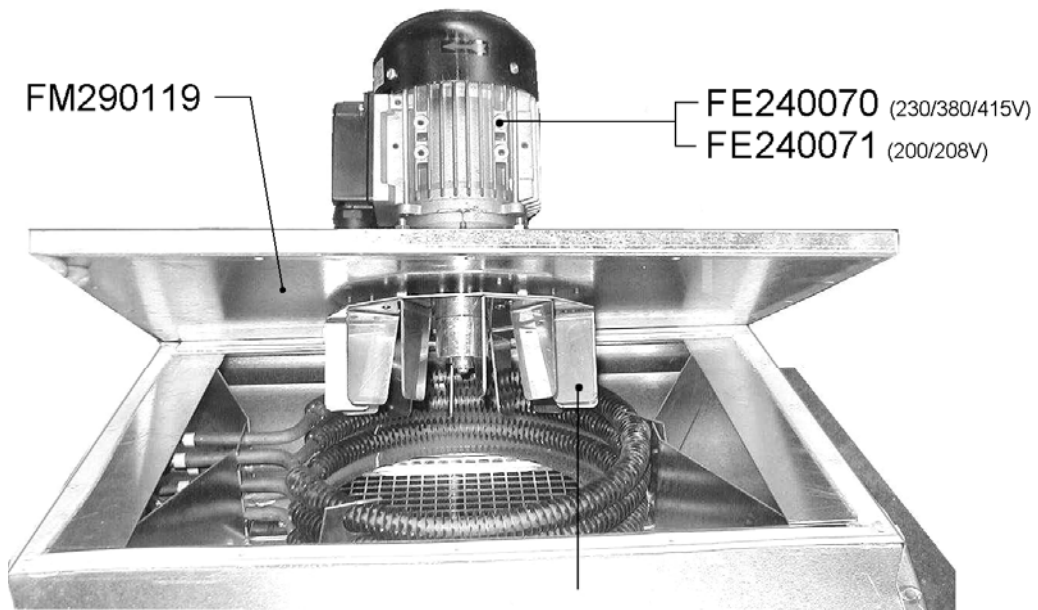

FM410003

Valido dalla matr. 329 del 07.2002 e per le matr. 313, 322, 324.
Valid from serial number 329 dated 07.2002 and the same for 313, 322, 324.

FM830051

(Old)

Valido dalla matr. 200 del 04.2001 e per le matr. 188, 189, 190, 195.
Valid from serial number 200 dated 04.2001 and the same for 188, 189, 190, 195.

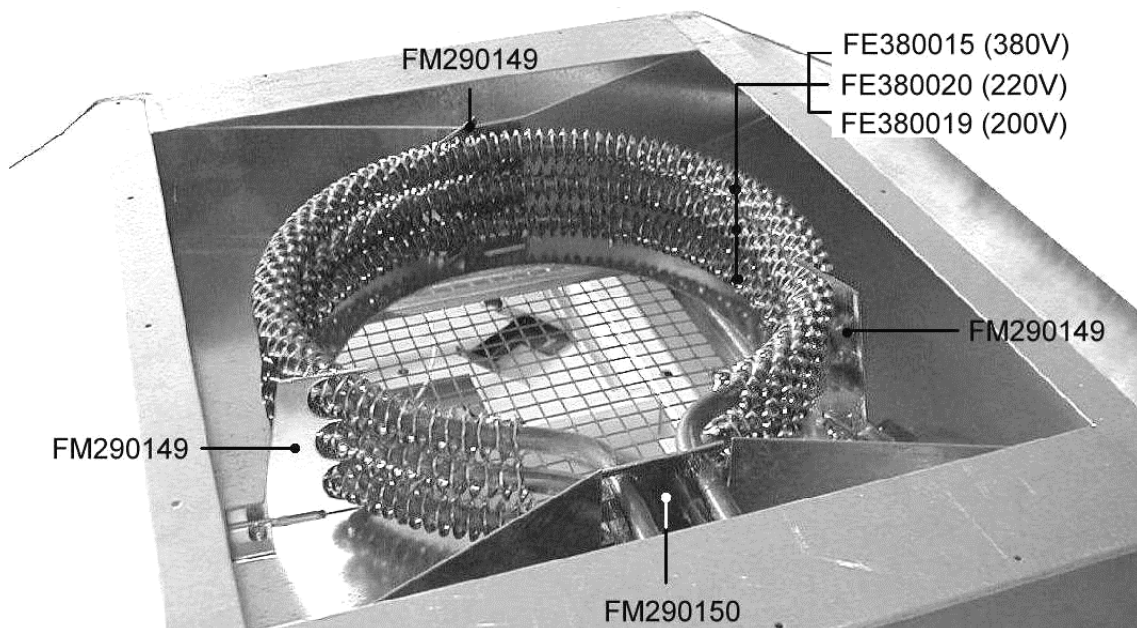

GRUPPO ELETTRICO (pannello comandi)
WIRING GROUP (control panel)

TAVOLA 11
SCHEME 11

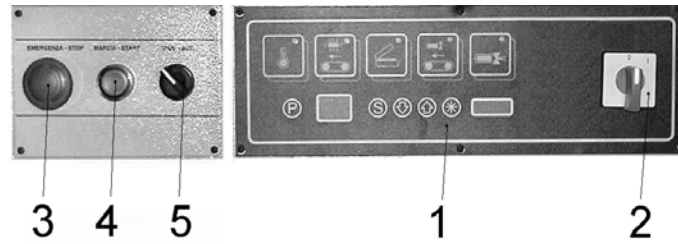

POS. POS.	CODICI PARTICOLARI ITEMS CODE	DENOMINAZIONI PARTICOLARI ITEMS DESCRIPTION	Q.tà Q.ty
1	S0190056	Pannello + scheda elettronica / Panel + electronic board	1
1.1	FE120363	Scheda elettronica / Electronic board	1
2	FE080001	Commutatore / Switch	1
3	FE340005	Pulsante di emergenza / Emergency pushbutton	1
4	FE340001	Pulsante di marcia / Start button	1
5	FE085004	Selettore manuale / Manual selector	1

GRUPPO ELETTRICO (cassetto)
WIRING GROUP (box)

TAVOLA 11.1
SCHEME 11.1

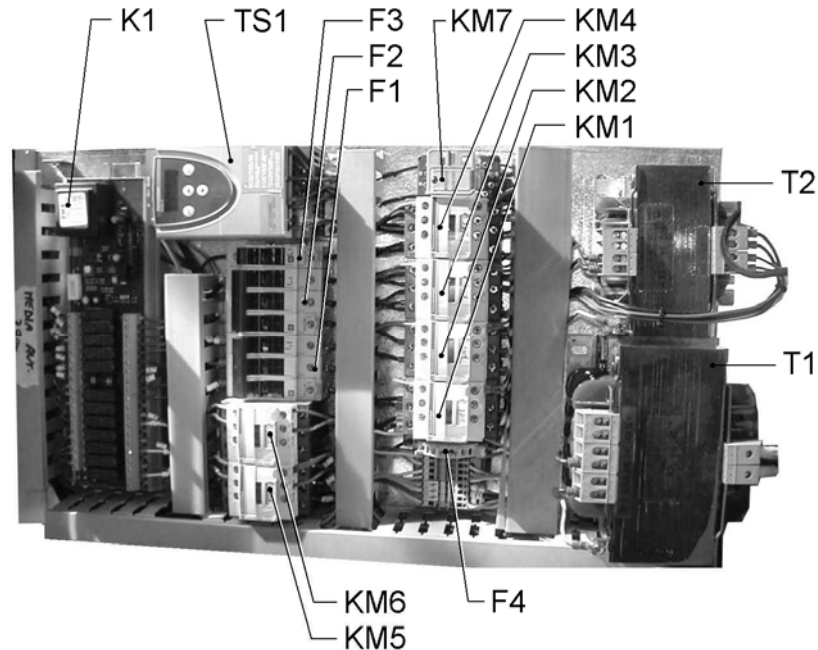

POS. POS.	CODICI PARTICOLARI ITEMS CODE	DENOMINAZIONI PARTICOLARI ITEMS DESCRIPTION	Q.tà Q.ty
F1	FE290405 FE290407 FE290408	Fusibile 10.3X38 AM 10A (380/415V) / Fuse 10.3X38 AM 10A (380/415V) Fusibile 10.3X38 AM 16A (230V) / Fuse 10.3X38 AM 16A (230V) Fusibile 10.3X38 AM 20A (200/208V) / Fuse 10.3X38 AM 20A (200/208V)	3
F2	FE290401	Fusibile 10.3X38 AM 2A / Fuse 10.3X38 AM 2A	3
F3	FE290401	Fusibile 10.3X38 AM 2A / Fuse 10.3X38 AM 2A	1
F4	FE290121	Fusibile 5X20 T 2A / Fuse 5X20 T 2A	1
KM1	FE110615	Contattore LC1-D18B7 / Contactor LC1-D18B7	1
KM2	FE110602 FE110615	Contattore LC1-D09B7 (380/415V) / Contactor LC1-D09B7 (380/415V) Contattore LC1-D18B7 (200/208/230V) / Contactor LC1-D18B7 (200/208/230V)	1
KM3	FE110602	Contattore LC1-D09B7 / Contactor LC1-D09B7	1
KM4	FE110602	Contattore LC1-D09B7 / Contactor LC1-D09B7	1
KM5	FE110602	Contattore LC1-D09B7 / Contactor LC1-D09B7	1
KM6	FE110602	Contattore LC1-D09B7 / Contactor LC1-D09B7	1
KM7	FE370006	Relè 24VAC / Relay 24VAC	1
K1	FE120353	Modulo di potenza / Electronic control board	1
TS1	KR170001	Inverter / Inverter	1
T1	FE440613 FE440612	Trasformatore 2400VA (380/415V) / Transformer 2400VA (380/415V) Trasformatore 2400VA (200/208/230V) / Transformer 2400VA (200/208/230V)	1
T2	FE440026 FE440025	Trasformatore 400VA (380/415V) / Transformer 400VA (380/415V) Trasformatore 400VA (200/208/230V) / Transformer 400VA (200/208/230V)	1

SCHEMA ELETTRICO
WIRING DIAGRAM

TAVOLA 12
SCHEME 12

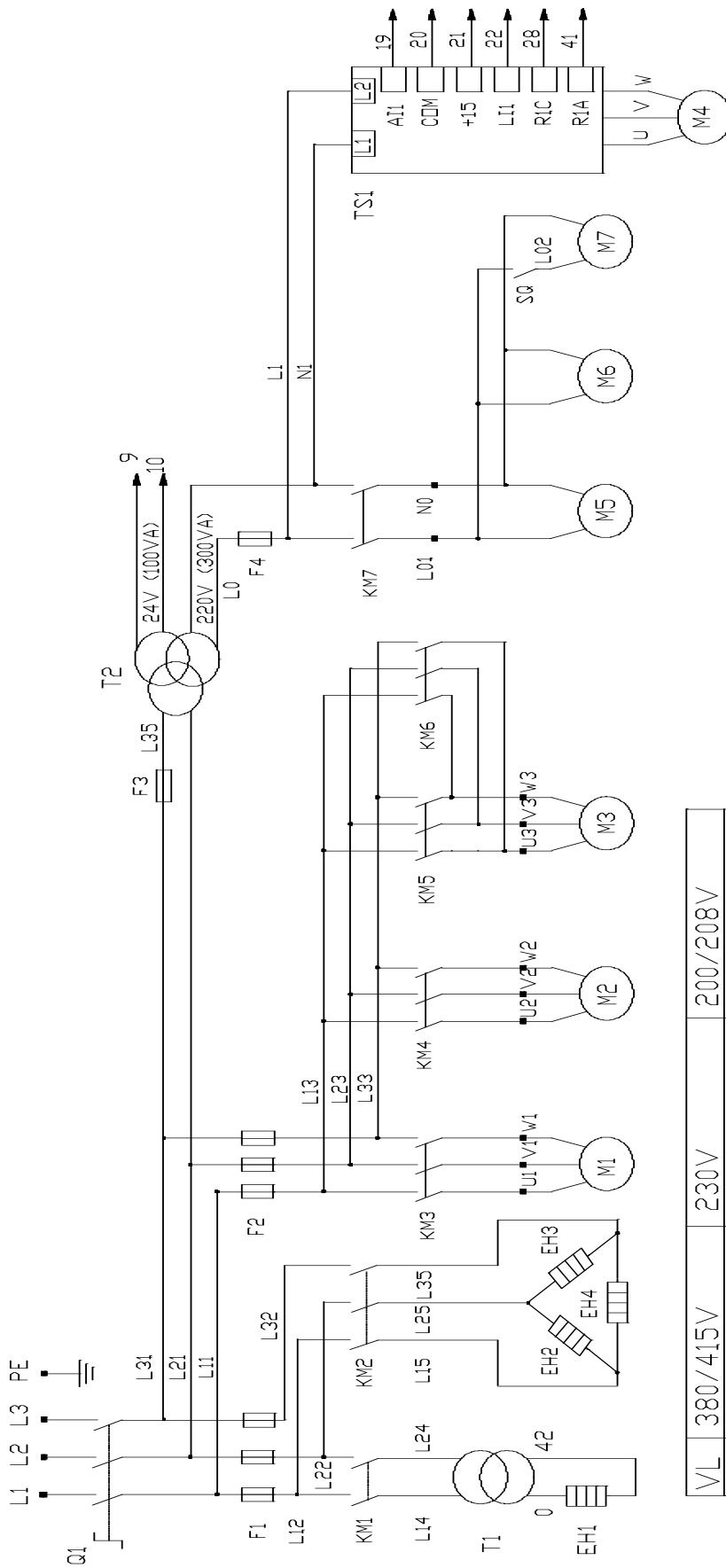

VL	380/415V	230V	200/208V
F1	AM 10A 450V	AM 16A 450V	AM 20A 450V
F2	AM 2A 450V	AM 2A 450V	AM 2A 450V
F3	AM 2A 450V	AM 2A 450V	AM 2A 450V
F4	T 2A 250V	T 2A 250V	T 2A 250V
FU	T 2A 250V	T 2A 250V	T 2A 250V

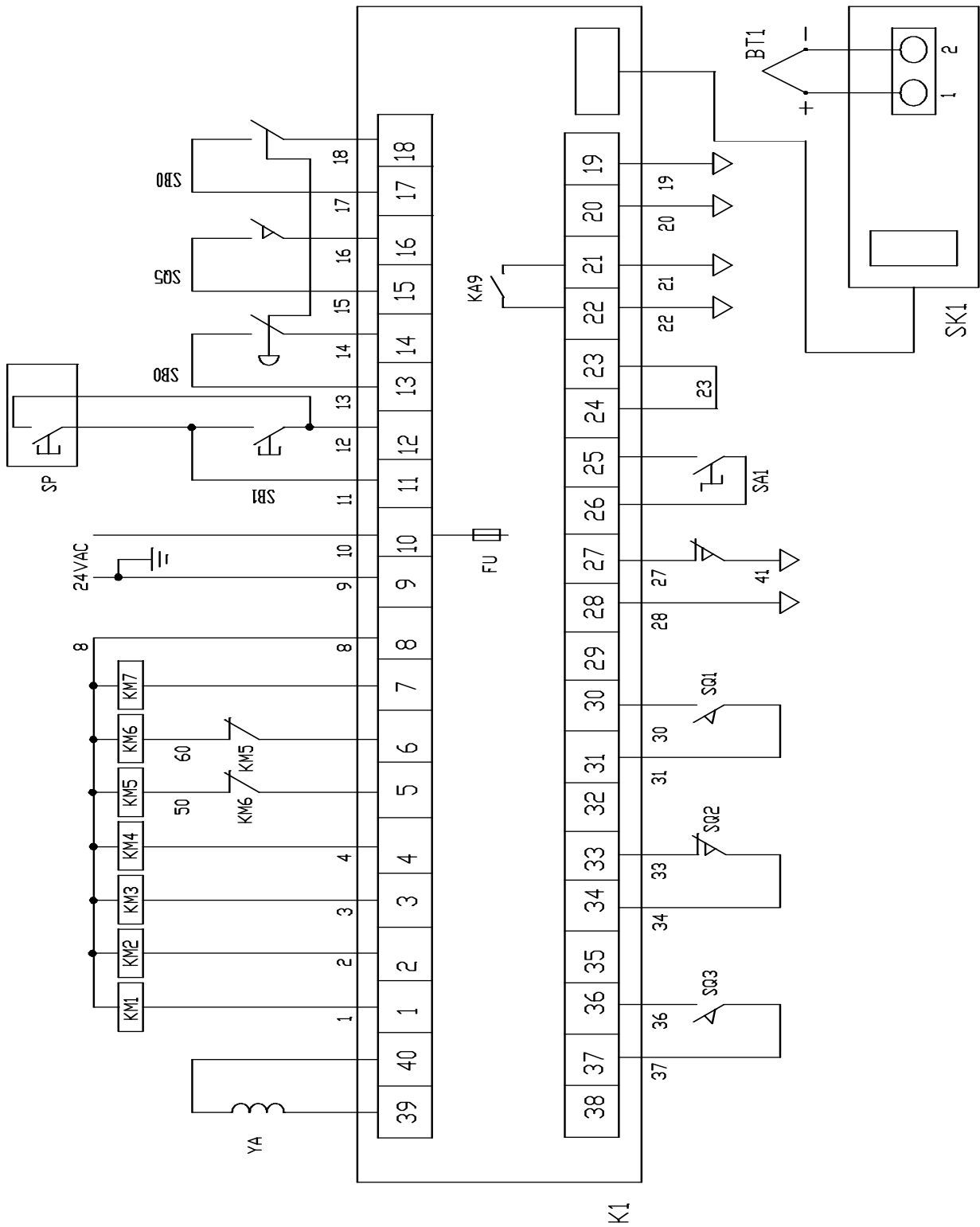

**LEGENDA SCHEMA ELETTRICO
WIRING DIAGRAM DESCRIPTION**

**TAVOLA 12.1
SCHEME 12.1**

Q1	Interruttore generale	Q1	Main switch
F1	Fusibili lama saldante / resistori 10.3X38	F1	Sealing blade / heaters fuse 10.3X38
F2	Fusibili motore ventola / nastro / telaio 10.3X38	F2	Fan / belt / frame motor fuse 10.3X38
F3	Fusibile trasformatore ausiliario 10.3X38	F3	Auxiliary transformer fuse 10.3X38
F4	Fusibile motori ventilatore / pompa 5X20	F4	Ventilator / pump motor fuse 5X20
FU	Fusibile scheda 5X20	FU	Board fuse 5X20
EH1	Resistenza di taglio	EH1	Cutting resistance
EH2	Resistori forno	EH2	Heater
EH3	Resistori forno	EH3	Heater
EH4	Resistori forno	EH4	Heater
M1	Motore ventola	M1	Fan motor
M2	Motore nastro saldatura	M2	Belt motor
M3	Motore automazione telaio	M3	Frame drive motor
M4	Motore nastro forno	M4	Belt oven motor
M5	Motore ventilatore	M5	Ventilator motor
M6	Motore pompa	M6	Pump motor
M7	Motore avvolgitore	M7	Winder motor
T1	Trasformatore di taglio	T1	Cut transformer
T2	Trasformatore ausiliario	T2	Auxiliary transformer
SQ	Finecorsa avvolgitore	SQ	Winder limit switch
SQ1	Finecorsa discesa telaio	SQ1	Frame lowering limit switch
SQ2	Finecorsa salita telaio	SQ2	Frame lifting limit switch
SQ3	Finecorsa esclusione sicurezza	SQ3	Safety device cutting out limit switch
SQ5	Finecorsa sicurezza	SQ5	Safety limit switch
KM1	Contattore taglio	KM1	Cutting contactor
KM2	Contattore resistori forno	KM2	Heaters contactor
KM3	Contattore ventola forno	KM3	Fan contactor
KM4	Contattore nastro	KM4	Sealing belt contactor
KM5	Contattore salita telaio	KM5	Frame descent contactor
KM6	Contattore discesa telaio	KM6	Frame rise contactor
KM7	Contattore accessori	KM7	Accessories contactor
SB0	Pulsante di emergenza	SB0	Emergency pushbutton
SB1	Pulsante di marcia	SB1	Start button
SA1	Selettore manuale	SA1	Manual selector
YA	Elettromagnete saldatura	YA	Sealing magnet
SP	Pedale (optional)	SP	Foot pedal
BT1	Termocoppia	BT1	Thermocouple
K1	Modulo di potenza	K1	Electronic control board
SK1	Scheda comando	SK1	Control board
TS1	Inverter	TS1	Inverter



Minipack-torre S.p.A.

Via Provinciale, 54 - 24044 DALMINE (BG) - ITALY

Tel. (035) 563525 – Fax (035) 564945

E-mail: info@minipack-torre.it

<http://www.minipack-torre.it>